

Rover Device (TC52) Carrying Clip



Audience: All Staff Using Rover Devices

Install and care of the Rover device carrying clip.

Care of the Carrying Clip

A great time to clean your Rover device is when you're changing the battery. Clean the carrying clip with the same disinfectant wipes you use for the phone. These are the PDI Easy Clean wipes.

- Remove the carrying clip before changing the battery.

Installation and Removal

These screenshots show how to install and remove the carrying clip.

1. Installation: From the top of the device, slide the carrying clip onto the device until it snaps into place.

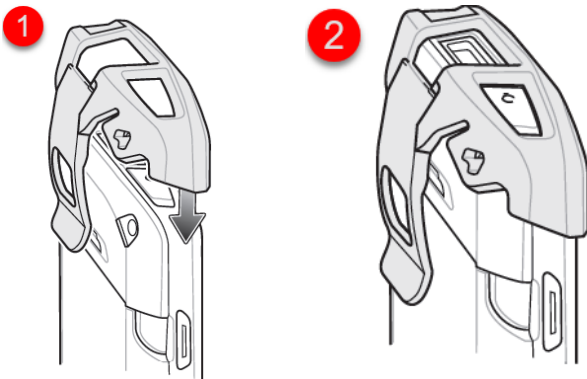

2. Removal: From the front of the carrying clip, push upward until it's removed.

